

### SLIP ON WELD

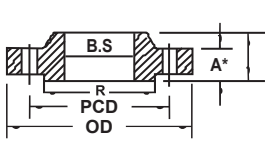

### WELD NECK

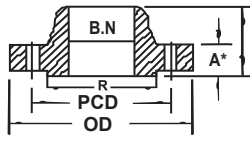

### BLIND

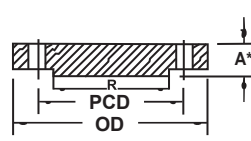

#### PN 10

Nominal Bore Size	15	20	25	32	40	50	65	80	100	125	150	200	250	300	350	400	450	500	600
OD Of Flange	95	105	115	140	150	165	185	200	220	250	285	340	395	445	505	565	615	670	780
PCD	65	75	85	100	110	125	145	160	180	210	240	295	350	400	460	515	565	620	725
Min Thick - A	14	16	16	16	16	18	18	20	20	22	22	24	26	26	26	26	26	28	28
Hub Length W/N	35	38	38	40	42	45	45	50	52	55	55	62	68	68	68	72	72	75	80
Bolt Hole DIA	14	14	14	18	18	18	18	18	18	18	22	22	22	22	22	26	26	26	30
No of Bolts	4	4	4	4	4	4	4	8	8	8	8	8	12	12	16	16	20	20	20
Raised Face Dia	45	58	68	78	88	102	122	138	158	188	212	268	320	370	430	482	532	585	685
B.S	22.3	27.7	34.5	43.2	49.5	62.0	74.7	90.7	116.1	143.8	170.7	221.5	276.3	327.1	359.1	410.5	461.8	513.1	615.9
B.N	15.7	20.8	26.7	35.1	40.9	52.6	62.7	78.0	102.4	128.3	154.2	202.7	254.5	304.8	336.5	387.3	438.1	488.9	590.5

#### PN 16

Nominal Bore Size	15	20	25	32	40	50	65	80	100	125	150	200	250	300	350	400	450	500	600
OD Of Flange	95	105	115	140	150	165	185	200	220	250	285	340	405	460	520	580	640	715	840
PCD	65	75	85	100	110	125	145	160	180	210	240	295	355	410	470	525	585	650	770
Min Thick - A	14	16	16	16	16	18	18	20	20	22	22	24	26	28	30	32	32	36	40
Hub Length W/N	35	38	38	40	42	45	45	50	52	55	55	62	70	78	82	85	85	90	95
Bolt Hole DIA	14	14	14	18	18	18	18	18	18	18	22	22	26	26	26	30	30	33	36
No of Bolts	4	4	4	4	4	4	4	8	8	8	8	12	12	12	16	16	20	20	20
Raised Face Dia	45	58	68	78	88	102	122	138	158	188	212	268	320	378	438	490	550	610	725
B.S	22.3	27.7	34.5	43.2	49.5	62.0	74.7	90.7	116.1	143.8	170.7	221.5	276.3	327.1	359.1	410.5	461.8	513.1	615.9
B.N	15.7	20.8	26.7	35.1	40.9	52.6	62.7	78.0	102.4	128.3	154.2	202.7	254.5	304.8	336.5	387.3	438.1	488.9	590.5

#### PN 25

Nominal Bore Size	15	20	25	32	40	50	65	80	100	125	150	200	250	300	350	400	450	500	600
OD Of Flange	95	105	115	140	150	165	180	200	235	270	300	360	425	485	555	620	670	730	845
PCD	65	75	85	100	110	125	145	160	190	220	250	310	370	430	490	550	600	660	770
Min Thick - A	16	18	18	18	18	20	22	24	24	26	28	30	32	34	38	40	40	44	46
Hub Length W/N	38	40	40	42	45	48	52	58	65	68	75	80	88	92	100	110	110	125	125
Bolt Hole DIA	14	14	14	18	18	18	18	18	22	26	26	26	30	30	30	36	36	36	39
No of Bolts	4	4	4	4	4	4	8	8	8	8	8	12	12	16	16	16	20	20	20
Raised Face Dia	45	58	68	78	88	102	122	138	162	188	218	278	335	390	450	505	555	615	720
B.S	22.3	27.7	34.5	43.2	49.5	62.0	74.7	90.7	116.1	143.8	170.7	221.5	276.3	327.1	359.1	410.5	461.8	513.1	615.9
B.N	15.7	20.8	26.7	35.1	40.9	52.6	62.7	78.0	102.4	128.3	154.2	202.7	254.5	304.8	336.5	387.3	438.1	488.9	590.5

#### PN 40

Nominal Bore Size	15	20	25	32	40	50	65	80	100	125	150	200	250	300	350	400	450	500	600
OD Of Flange	95	105	115	140	150	165	180	200	235	270	300	375	450	515	580	660	685	755	890
PCD	65	75	85	100	110	125	145	160	190	220	250	320	385	450	510	585	610	670	795
Min Thick - A	16	18	18	18	18	20	22	24	24	26	28	34	38	42	46	50	50	52	54
Hub Length W/N	38	40	40	42	45	48	52	58	65	68	75	88	105	115	125	135	135	140	145
Bolt Hole DIA	14	14	14	18	18	18	18	18	22	26	26	30	33	33	33	39	39	42	48
No of Bolts	4	4	4	4	4	4	8	8	8	8	8	12	12	16	16	16	20	20	20
Raised Face Dia	45	58	68	78	88	102	122	138	162	188	218	285	345	410	465	535	560	615	735
B.S	22.3	27.7	34.5	43.2	49.5	62.0	74.7	90.7	116.1	143.8	170.7	221.5	276.3	327.1	359.1	410.5	461.8	513.1	615.9
B.N	15.7	20.8	26.7	35.1	40.9	52.6	62.7	78.0	102.4	128.3	154.2	202.7	254.5	304.8	336.5	387.3	438.1	488.9	590.5